

72 Talbot St Rishton BB1 4NZ

Approximate Gross Internal Area

837 sq ft - 78 sq m

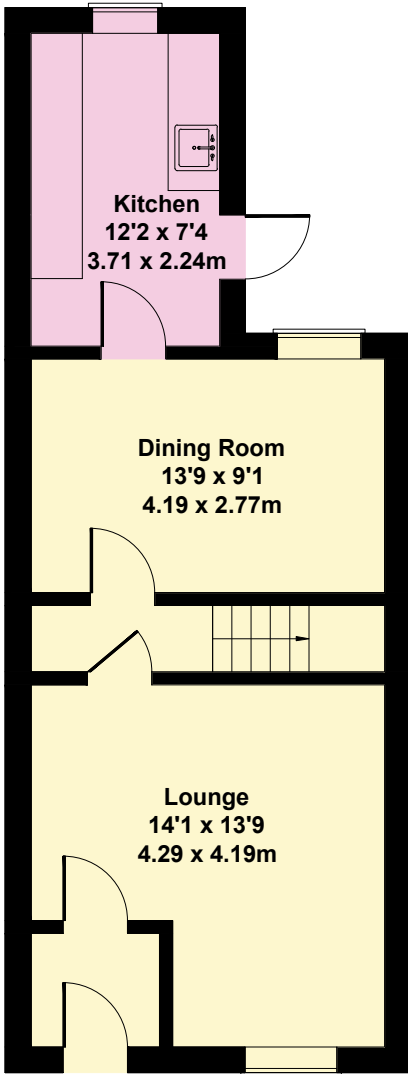

GROUND FLOOR

Office/Playroom
9'4 x 7'2
2.84 x 2.18m

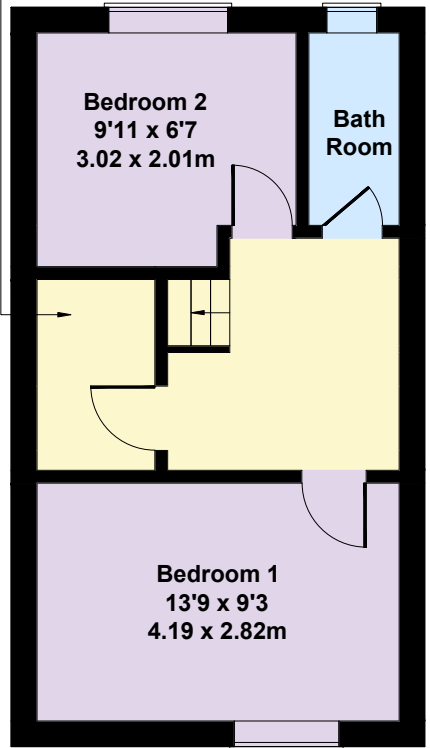

FIRST FLOOR



Not to Scale. Produced by The Plan Portal 2026
For Illustrative Purposes Only.